

BLANKET TO EXTEND A MINIMUM OF 3'-0" BEYOND TOE OF SLOPE FOR BOTTOM OF SLOPE TERMINATION, SEE DETAIL 3/9

FOR END ROLL OVERLAP, SEE DETAIL 2/9

SIDE SEAM OVERLAP, SEE DETAIL 7/9

**SLOPE DETAIL**  
NO SCALE

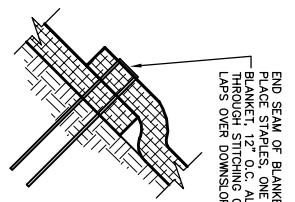

END SEAM OF BLANKETS OVERLAP 2'-4" PLACE STAPLES, ONE ON EACH CORNER OF BLANKET, 12" O.C. ALONG BLANKET END THROUGH STITCHING ON BOTH BLANKETS. UPSLOPE BLANKET LAPS OVER DOWNSLOPE BLANKETS IN A SHINGLE AFFECT.

**END ROLL OVERLAP**  
NO SCALE

2  
9

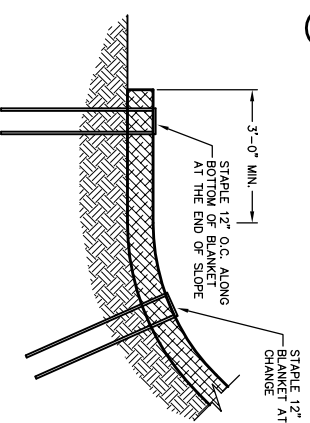

STAPLE 12" O.C. ALONG BLANKET AT SLOPE CHANGE

STAPLE 12" O.C. ALONG AT THE END OF SLOPE

**BOTTOM OF SLOPE TERMINATION**  
NO SCALE

3  
9

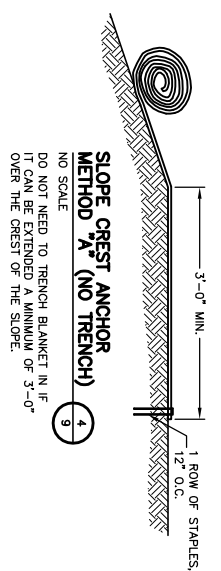

**SLOPE CREST ANCHOR METHOD A (NO TRENCH)**  
NO SCALE  
DO NOT NEED TO TRENCH BLANKET IN IF IT CAN BE EXTENDED A MINIMUM OF 3'-0" OVER THE CREST OF THE SLOPE.

4  
9

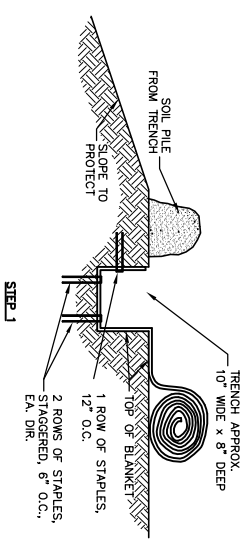

**STEP 1**

2 ROWS OF STAPLES, STAGGERED, 6" O.C., EA. DIR.

2 ROWS OF STAPLES, STAGGERED, 6" O.C., EA. DIR.

1 ROW OF STAPLES, 12" O.C.

TOP OF BLANKET

SLOPE TO PROTECT

FROM TRENCH

SOIL PILE

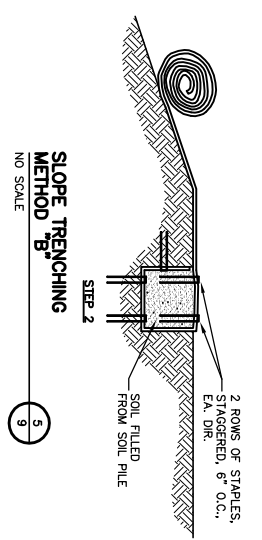

**STEP 2**

2 ROWS OF STAPLES, STAGGERED, 6" O.C., EA. DIR.

2 ROWS OF STAPLES, STAGGERED, 6" O.C., EA. DIR.

1 ROW OF STAPLES, 12" O.C.

SOIL FILLED FROM SOIL PILE

**SLOPE TRENCHING METHOD B**  
NO SCALE

5  
9

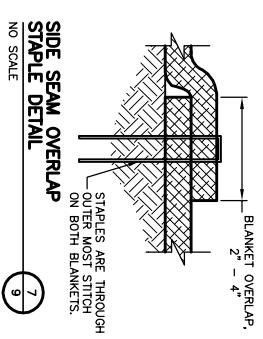

**SIDE SEAM OVERLAP STAPLE DETAIL**  
NO SCALE

7  
9

**NOTES:**  
1. STAPLE PATTERNS ARE DEPENDENT ON SITE CONDITIONS. SEE CURLEX® NETTRE™ STAPLE PATTERN GUIDE FOR DETAILS.  
2. E-STAPLES MAY BE USED IN PLACE OF WIRE STAPLES.

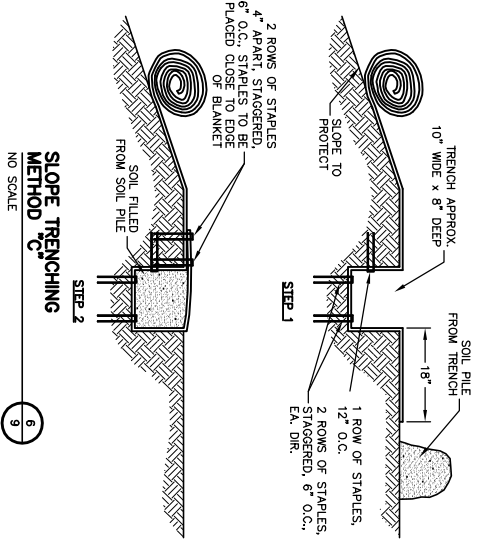

**STEP 1**

2 ROWS OF STAPLES, STAGGERED, 6" O.C., EA. DIR.

1 ROW OF STAPLES, 12" O.C.

SOIL PILE

FROM TRENCH

18"

TRENCH APPROX. 10" WIDE x 8" DEEP

SLOPE TO PROTECT

FROM SOIL PILE

**SLOPE TRENCHING METHOD C**  
NO SCALE

6  
9



**STEP 2**

4" APART, STAGGERED, 6" O.C. STAPLES TO BE FLAGGED OUTSIDE OF BLANKET

SOIL FILLED FROM SOIL PILE

FROM SOIL PILE

**SLOPE TRENCHING METHOD C**  
NO SCALE

6  
9

NO.	REV.	DATE	REVISIONS	PROJECT MANAGER	APPROVED BY	SHEET DESCRIPTION	SCALE	DATE	DRAWN BY	SHEET NO.
						AMERICAN EXCELSIOR COMPANY		4/17/03		9
						ARLINGTON, TEXAS				
						SLOPE APPLICATION DETAIL				
						CURLEX® NETTRE™				
						Earth Science Division				

